



Hexa Precision Industries

"House of Hydraulic Pumps, PTO's & Accessories"



GLOBAL FOOT PRINTS

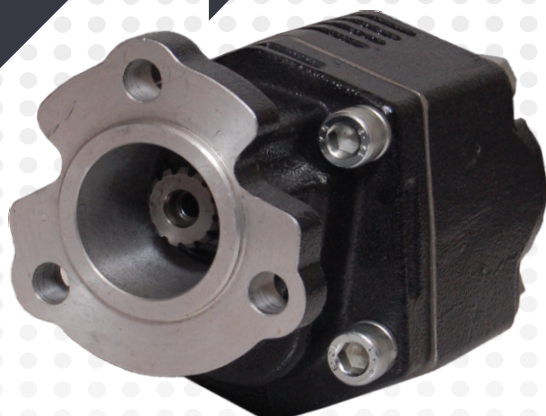

HS SERIES-UNI3-BOLT PUMPS

Uniquely designed with Steel body and Aluminium cover in 3 Bolt configurations; being introduced in India for the first time, these pumps can work under high pressure (upto 280 bar) where flow requirement is low but demanding. Very compact design, durable and designed for multiple applications.

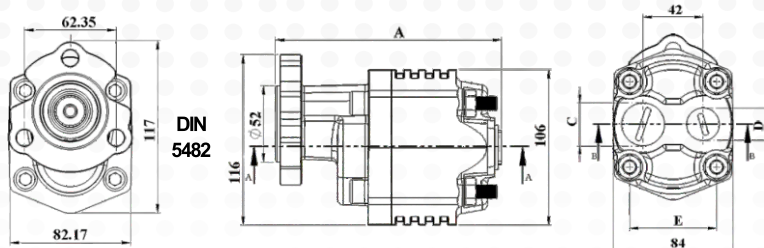

KEY FEATURES

- 5 Standard sizes
- Compact design
- Pressure up to 250 bar
- Speed up to 2200 RPM
- Shaft DIN 5482 (13X19X22)
- Low noise level
- Rear Ports
- Dowel bush design
- Maximum Efficiency
- Stringent Quality Testing

MODEL NUMBER CONSTRUCTION-HS3 11 ACWRP

Series Code	Mounting Flange	Displacement@1000 RPM	Direction type	Port Type
HS	UNI 3 Bolt	11cc / 16cc / 22cc 25cc/ 30cc	CW: Clockwise ACW: Anti-clockwise	RP - Rear Port

PUMP SPECIFICATIONS

Model	Mounting Flange	Displacement (cc)	RPM Min. - Max.	Continuous RPM	Max Working Pressure (BAR)	Ports Inlet/ Outlet	Inlet Vacuum (Bar)	Weight (KG)
HS311ACWRP	UNI 3-BOLT	11cc	450 - 2200	1500	280	3/4"G 1/2"G	0.7- 3.0 bar	3.4kg
HS316ACWRP	UNI 3-BOLT	16cc	450 - 2200	1500	280	3/4"G 1/2"G	0.7- 3.0 bar	3.8kg
HS322ACWRP	UNI 3-BOLT	22cc	450 - 2200	1500	260	3/4"G 1/2"G	0.7- 3.0 bar	4.1kg
HS325ACWRP	UNI 3-BOLT	25cc	450 - 2200	1500	240	3/4"G 1/2"G	0.7- 3.0 bar	4.4kg
HS330ACWRP	UNI 3-BOLT	30cc	450 - 2200	1500	200	3/4"G 1/2"G	0.7- 3.0 bar	4.9kg

PG-1



House of Hydraulic Pumps, PTO's & Accessories

info@hexaprecision.com www.hexaprecision.com