



Hexa Precision Industries

"House of Hydraulic Pumps, PTO's & Accessories"



GLOBAL FOOT PRINTS

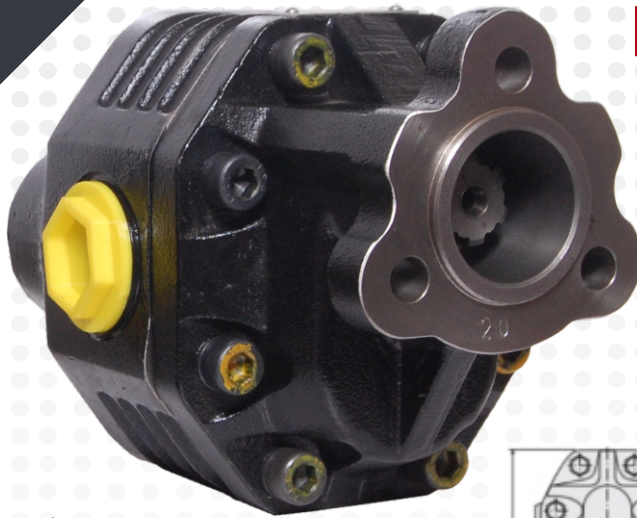

HR SERIES – UNI3-BOLT PUMPS

Rear Port Pumps in 3-Bolt Configuration are being introduced in India for the first time pioneered by HEXA. Designed for Space-saving and easier installation, HR Series offers compact design with high efficiency and unmatched durability.

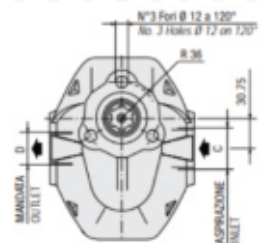
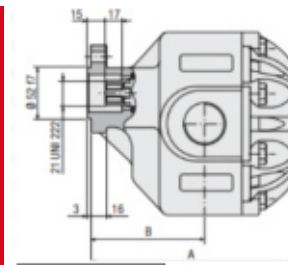
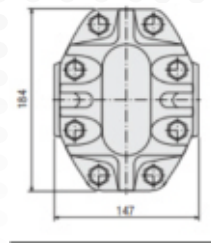

KEY FEATURES

- 3 Standard sizes
- Compact design
- Pressure up to 250 bar
- Speed up to 2400 RPM
- Shaft 21 UNI 222 (6X21X25)
- Low noise level
- Rear Ports
- Dowel pin design
- Maximum Efficiency
- Stringent Quality Testing

MODEL NUMBER CONSTRUCTION – HR 3 45 BD 2P

Series Code	Mounting Flange	Displacement@1000 RPM	Direction type	Port Type
HR	UNI 3 Bolt	45cc / 65cc / 83cc	BD: Bi-Directional	2P - Side Port 4P - 4 Port RP - Rear Port

PUMP SPECIFICATIONS

Model	Mounting Flange	Displacement (cc)	RPM Min. - Max.	Continuous RPM	Max Working Pressure (BAR)	Ports Inlet/ Outlet	Inlet Vacuum (Bar)	Weight (KG)
HR345BD4P	UNI 3-BOLT	45cc	600 - 2400	1500	190	G1" BSP	0.7- 3.0 bar	10.5 KG
HR365BD4P	UNI 3-BOLT	65cc	600 - 2400	1500	190	G1" BSP	0.7- 3.0 bar	12.6 KG
HR383BD4P	UNI 3-BOLT	83cc	600 - 2400	1500	190	G1" BSP	0.7- 3.0 bar	14.9 KG

